

Vecsés, Airport Office Park
(the original building may have been altered for educational purposes)

Designer: Lukács és Vikár Építészstúdió
Lukács István, Vikár András DLA, Gál Árpád

The building is located next to a very bus motorway. The area of the basement is larger than the building above to accommodate the necessary number of cars. The building is divided into two main parts which form a Z shape. The main atrium spans the whole height of the building as a single space. The office areas are designed to accommodate both an open plan and a cell based use.

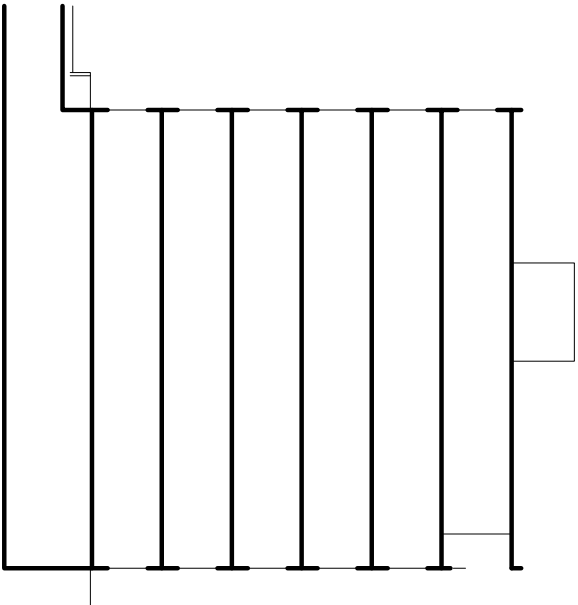

A-A Section M=1:400