



Budapest University of Technology and Economics
Faculty of Architecture Engineering
Department of Building Constructions



NON EXPLOITED FLAT ROOFS

DETAILS

Horváth Sándor - Fülöp Zsuzsanna Ph.D

Budapest 2017.

STRUCTURAL CONNECTIONS

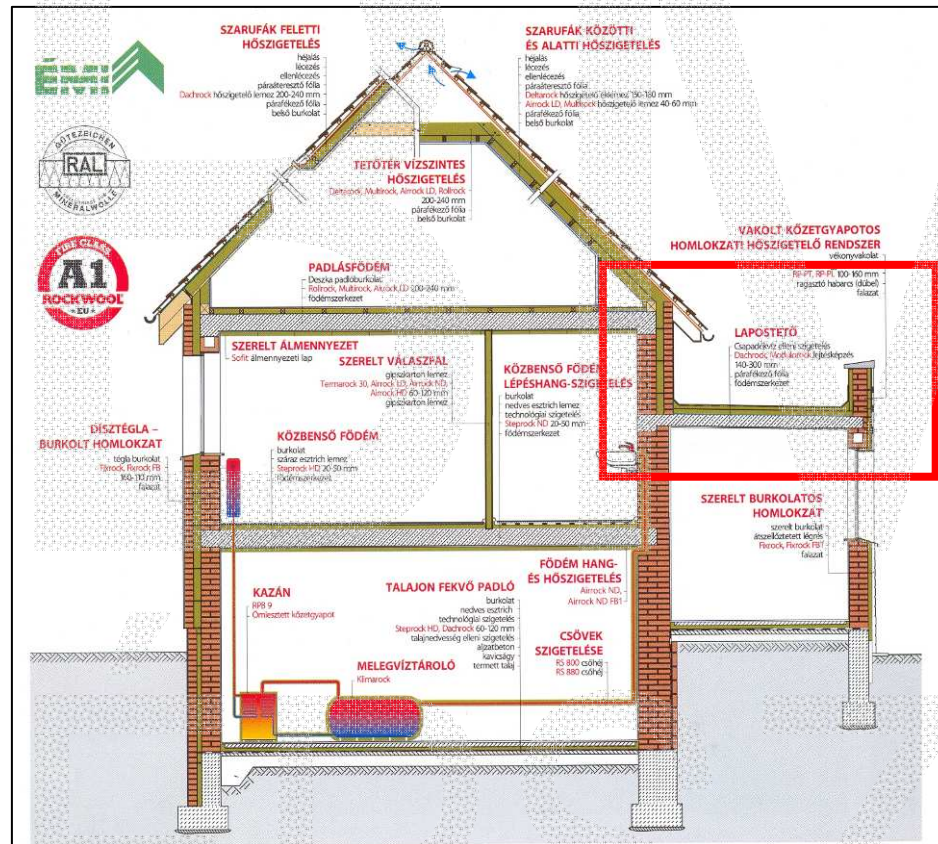

FLAT ROOFS



EVALUATION IN THE CONTEXT OF THE WHOLE BUILDING



DETAILS OF FLATROOFS

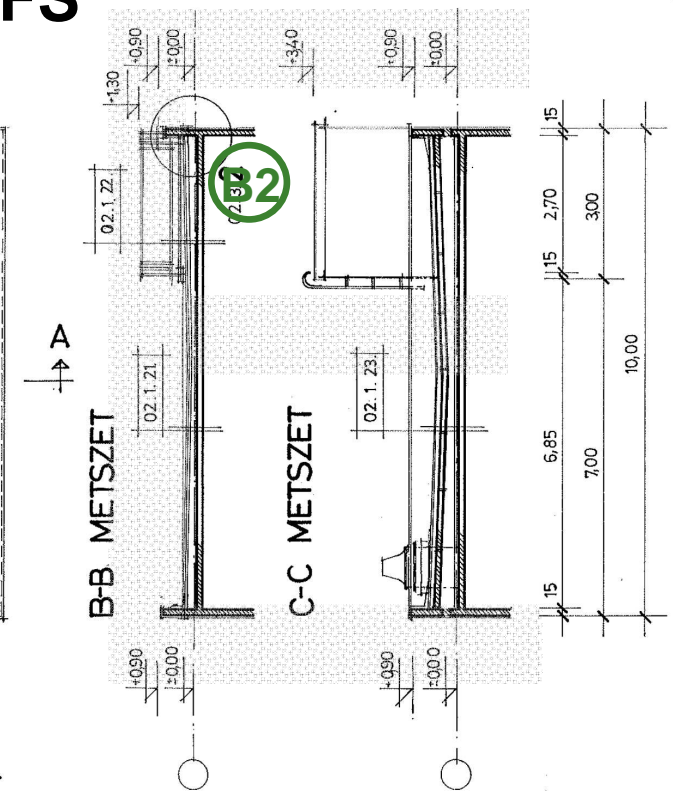
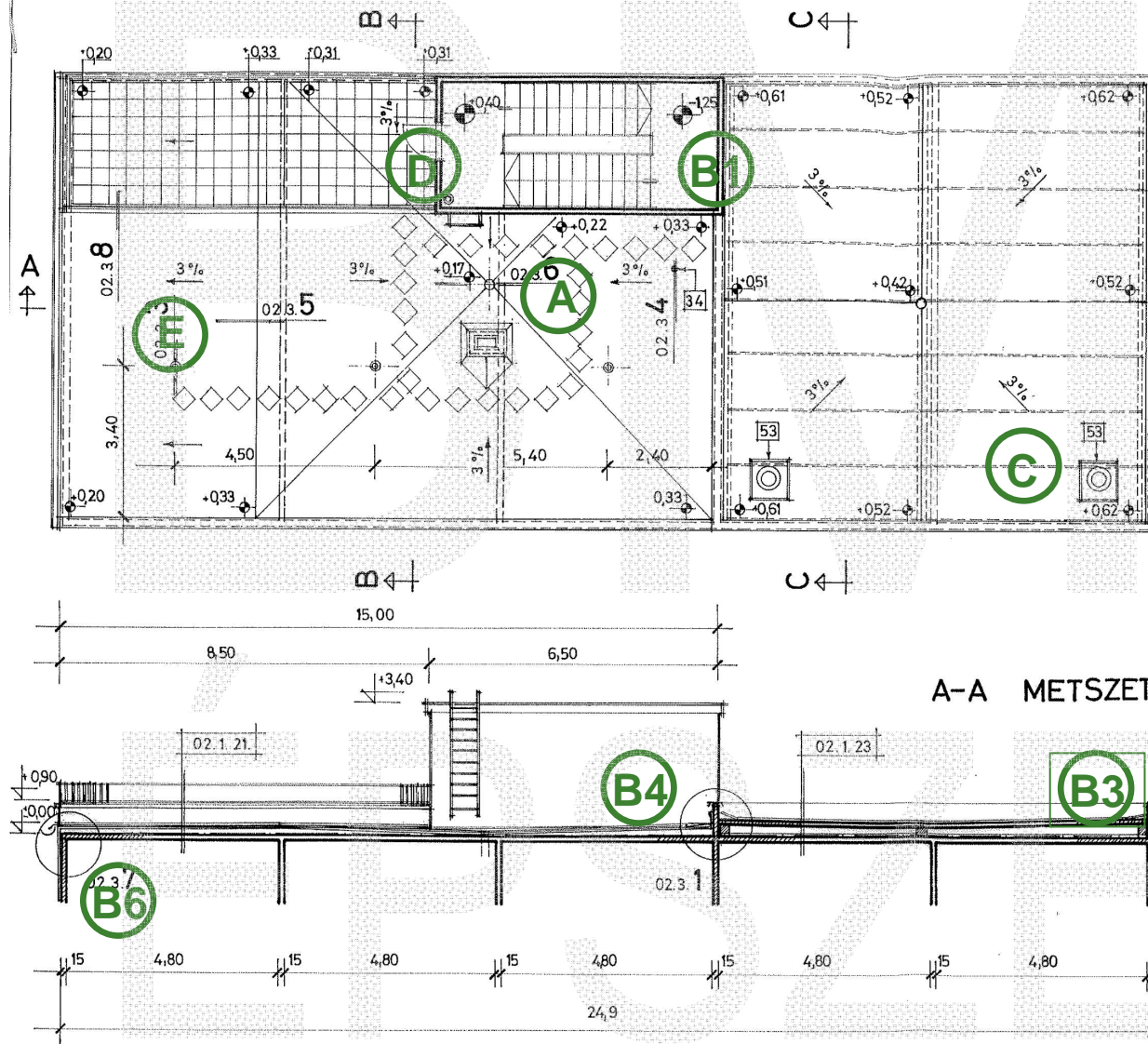

A gully
B flashing
C skylight
D door
E pipes

INTERNAL DRAIN SYSTEM

Gully

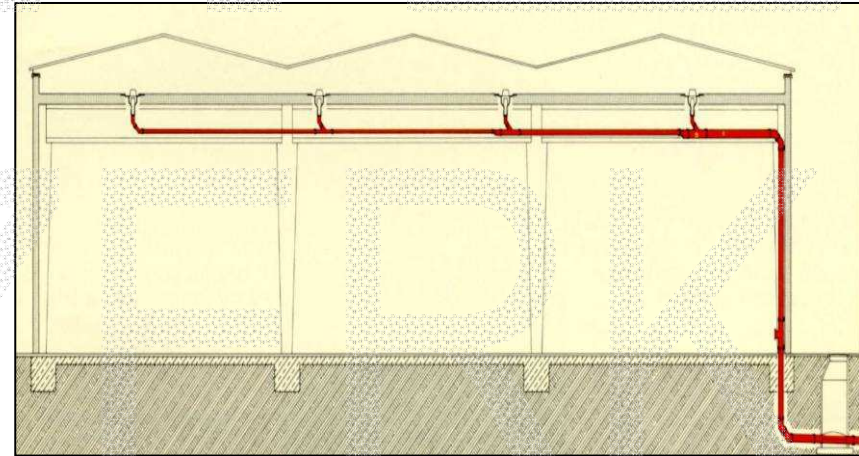
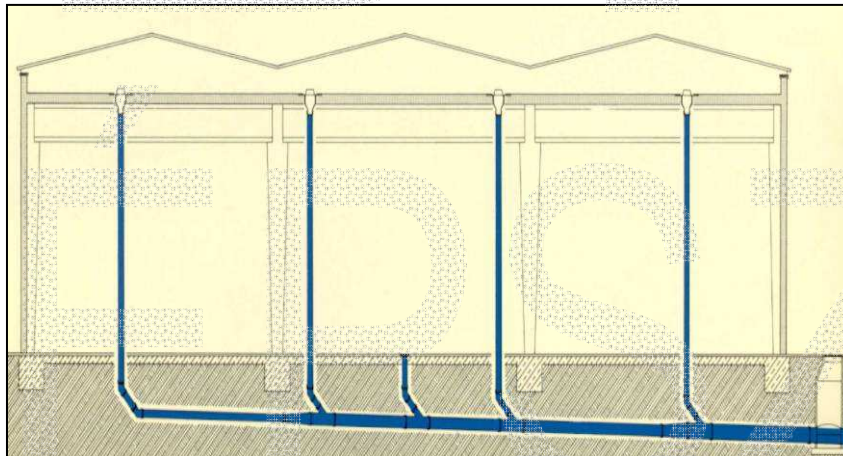
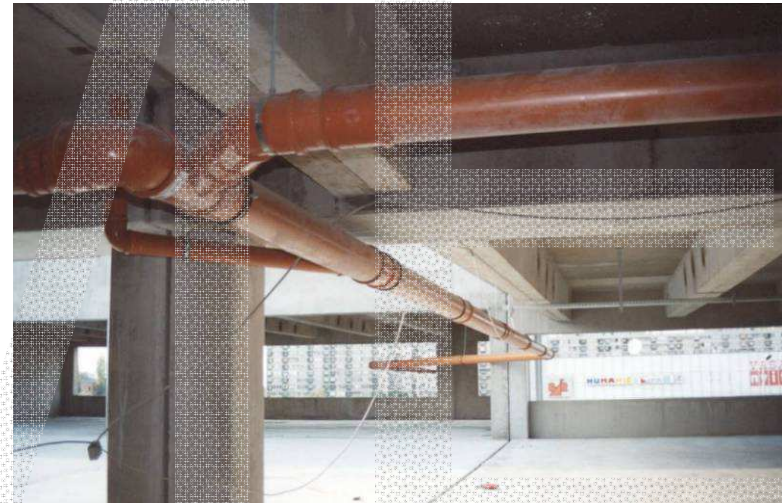
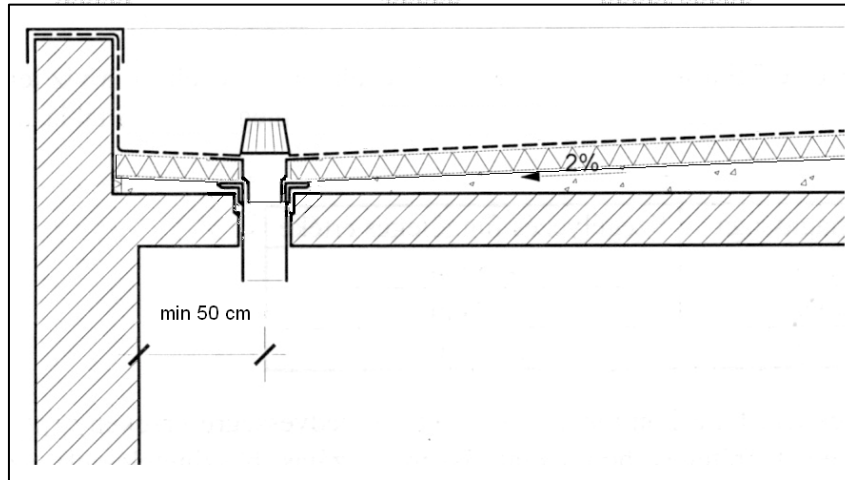

FLAT ROOFS

RAINWATER DRAIN SYSTEM

Internal outlet: gully

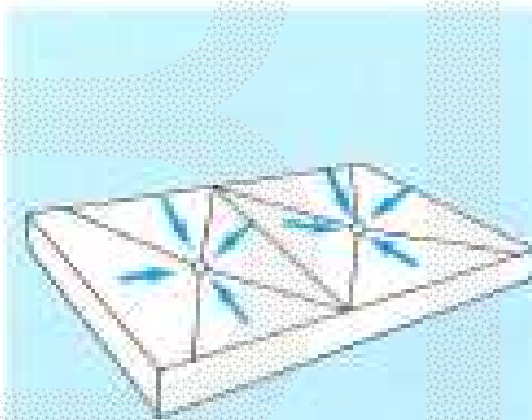

awaplan-Dachablauf PU DBGM e.
Prüfzeichen PA12661

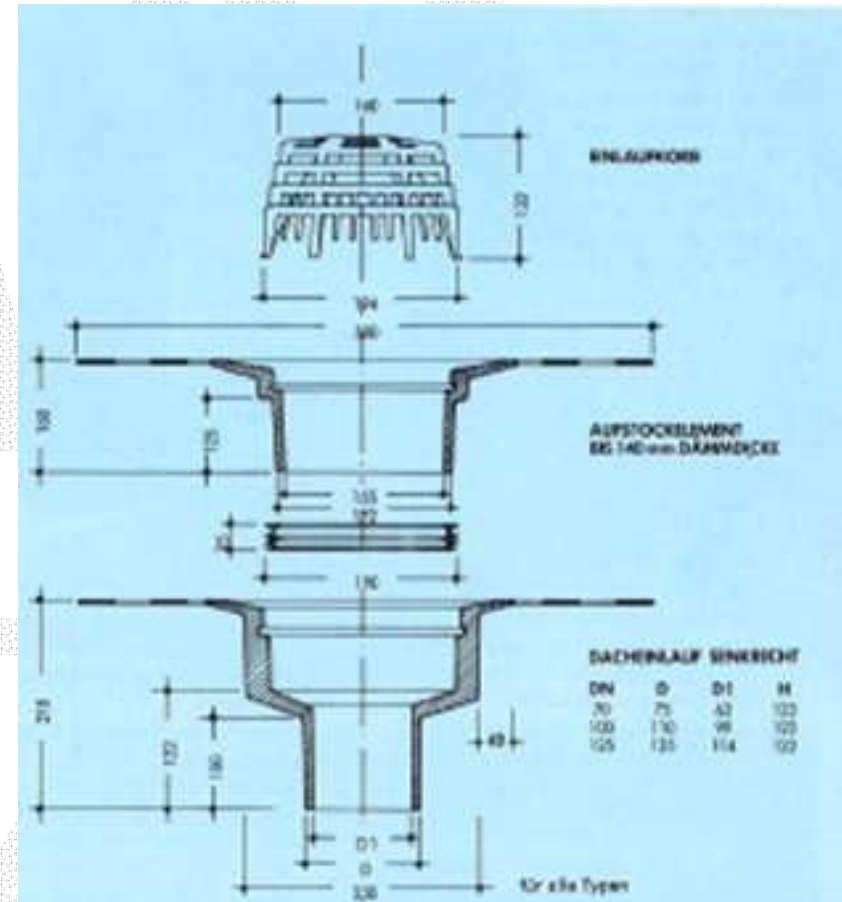

FLASHING OF GULLIES

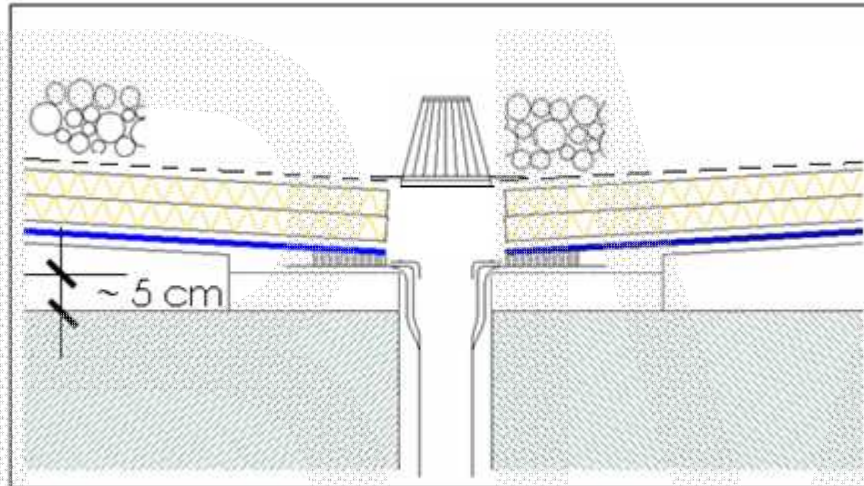

Inverted – single gully

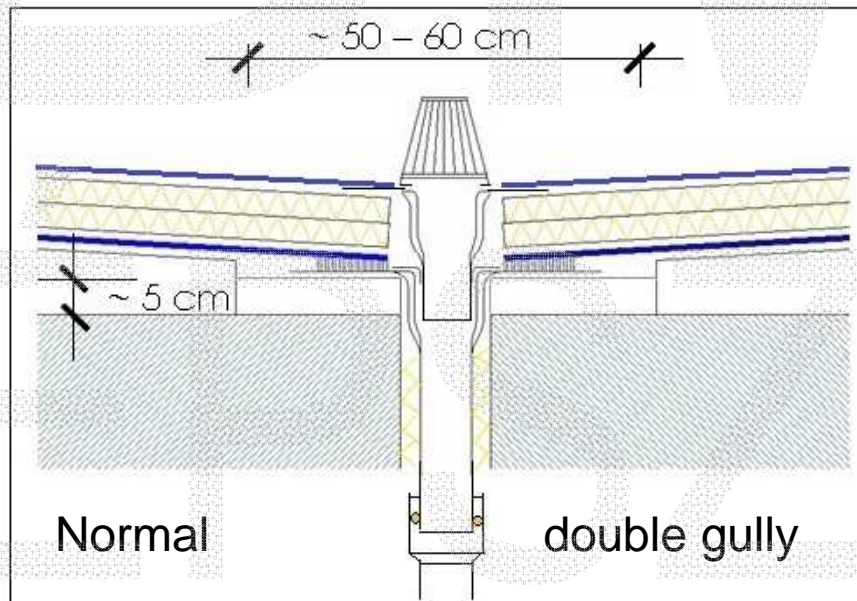

Normal

double gully

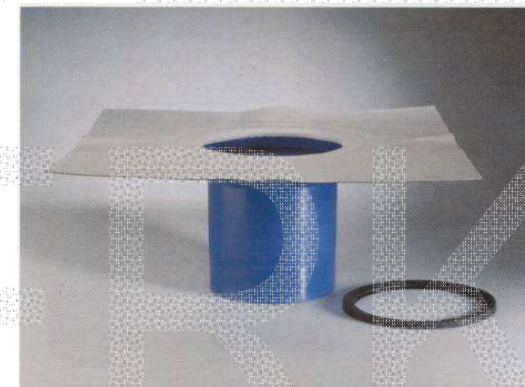
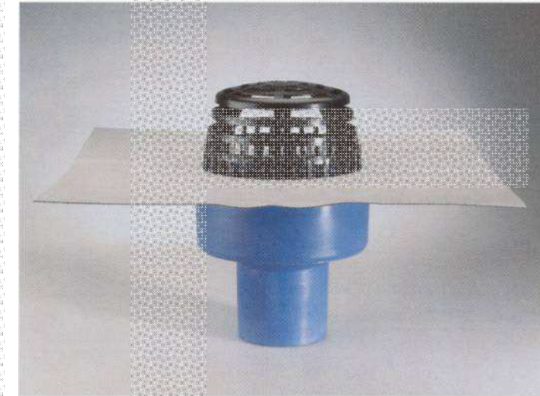

FLASHING OF GULLIES

BITUMINOUS ROOFING MEMBRANES

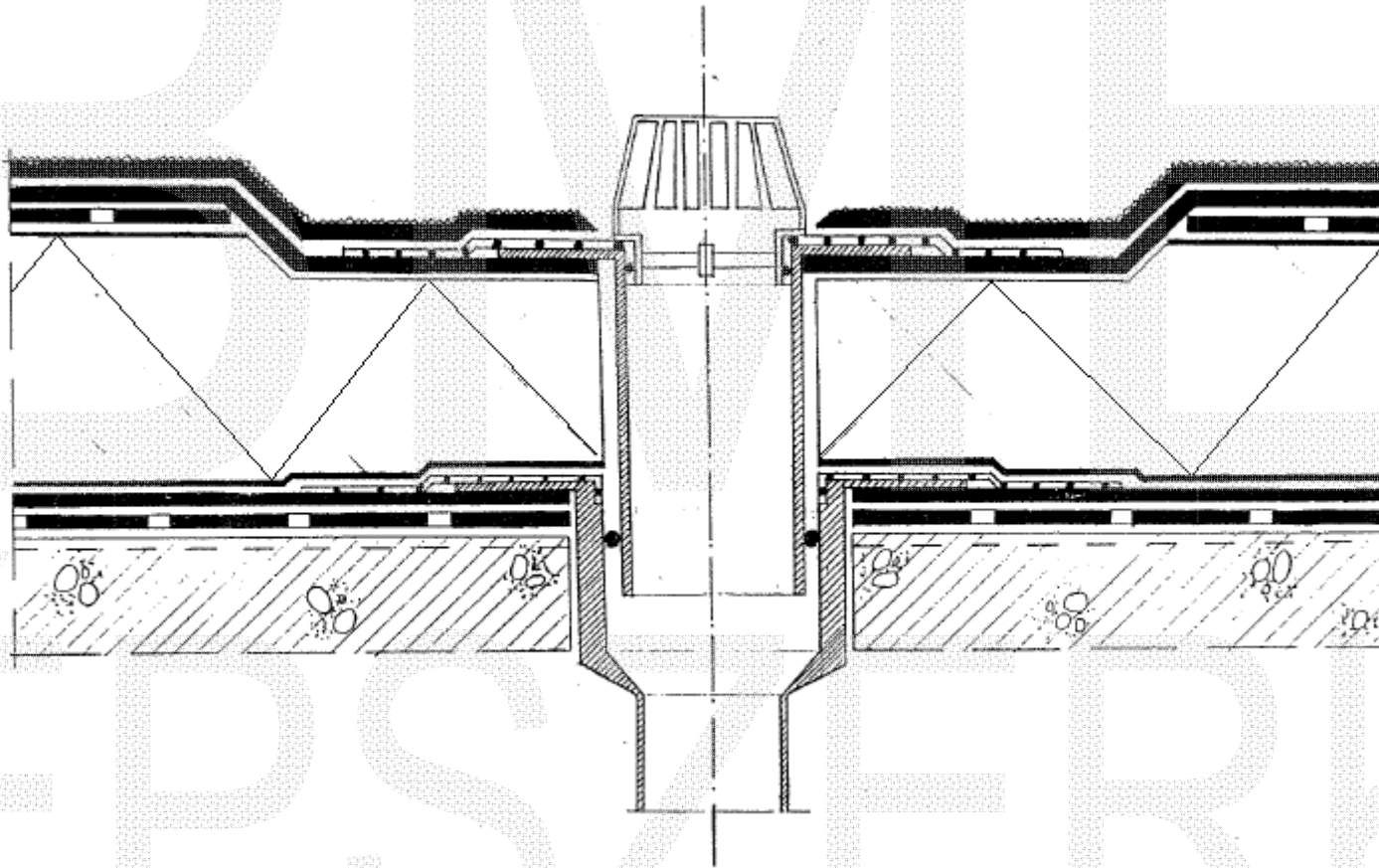

FLASHING OF GULLIES

BITUMINOUS ROOFING MEMBRANES

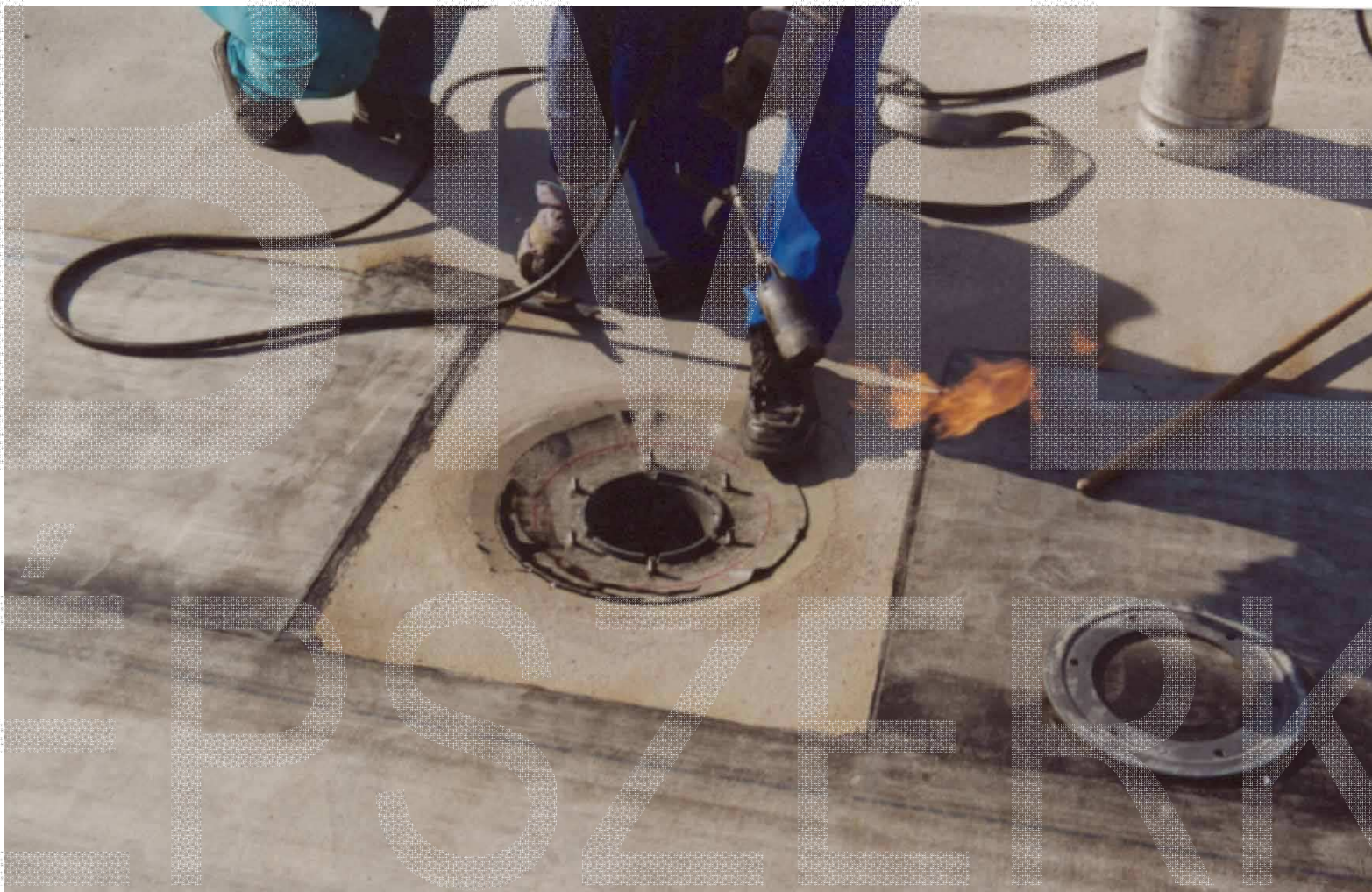

FLASHING OF GULLIES

BITUMINOUS ROOFING MEMBRANES



FLASHING OF GULLIES

PLASTIC ROOFING MEMBRANES

inverted

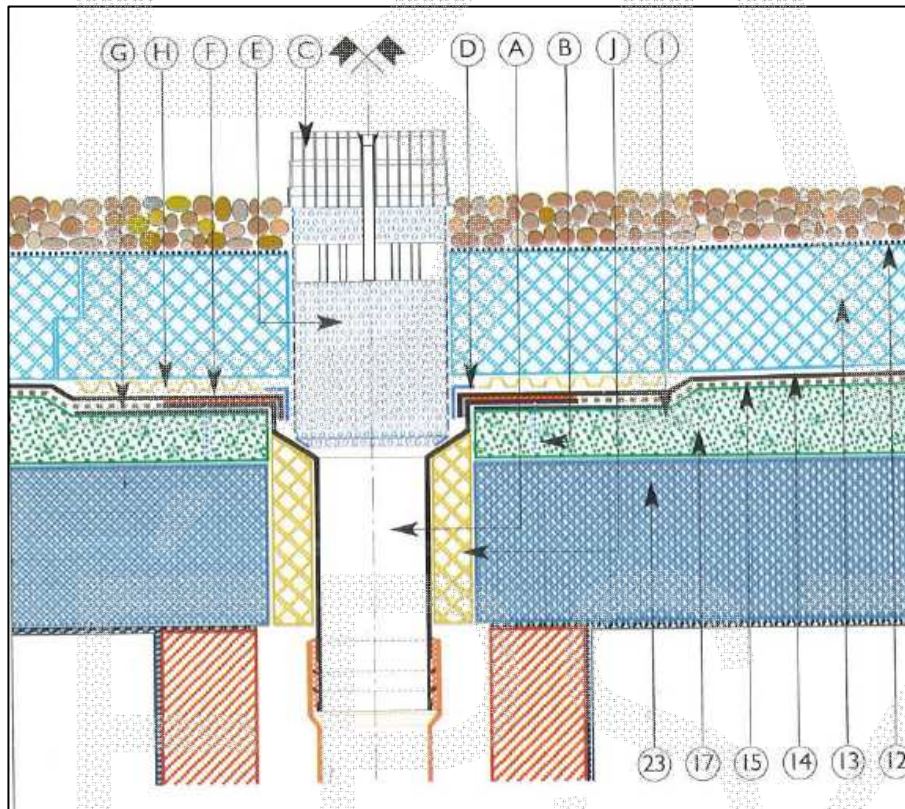

normal

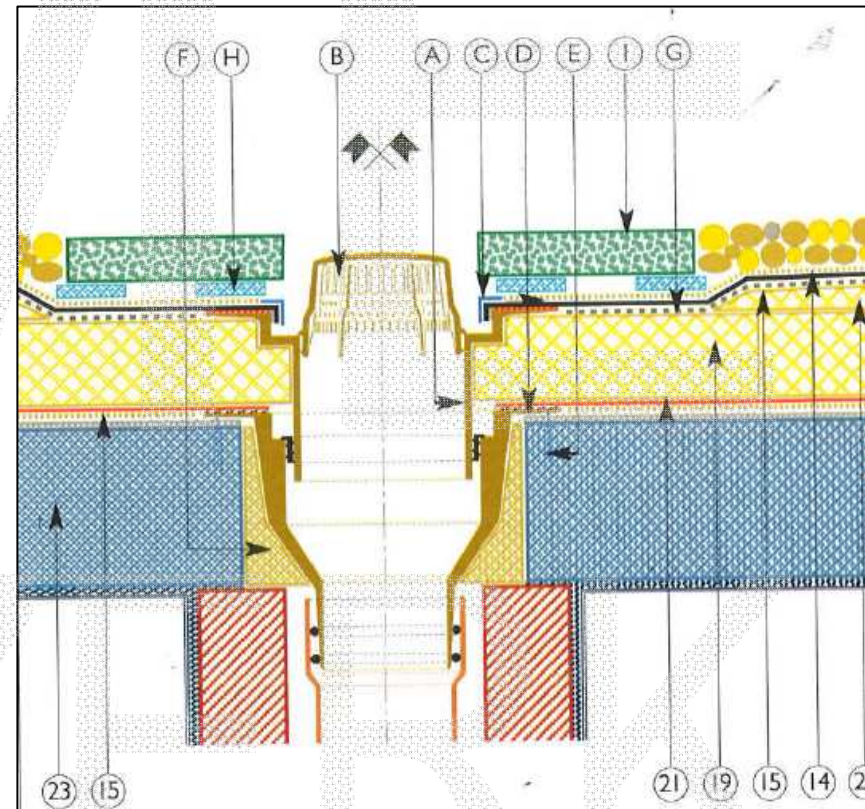

FLASHING OF GULLIES



PLASTIC ROOFING MEMBRANES

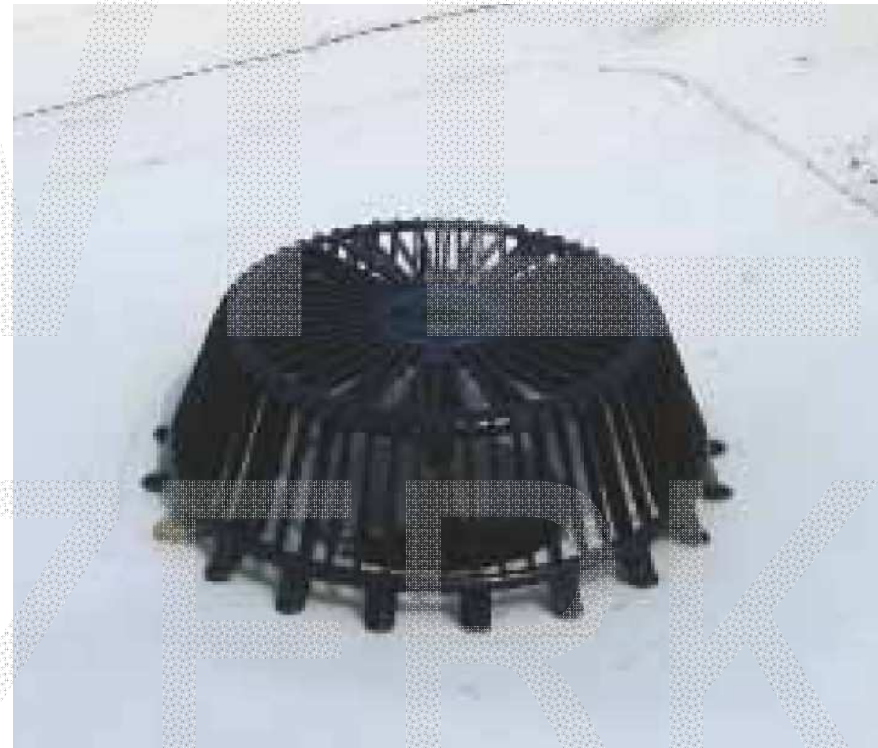

FLAT ROOFS

EXTERNAL POINT WISE DRAIN SYSTEM

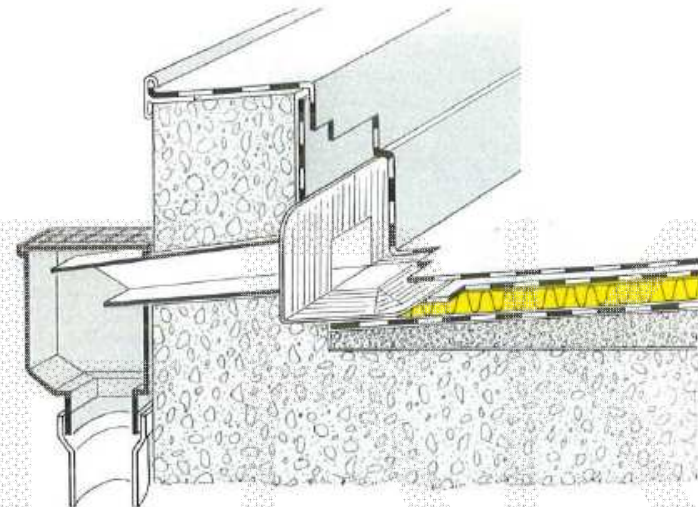
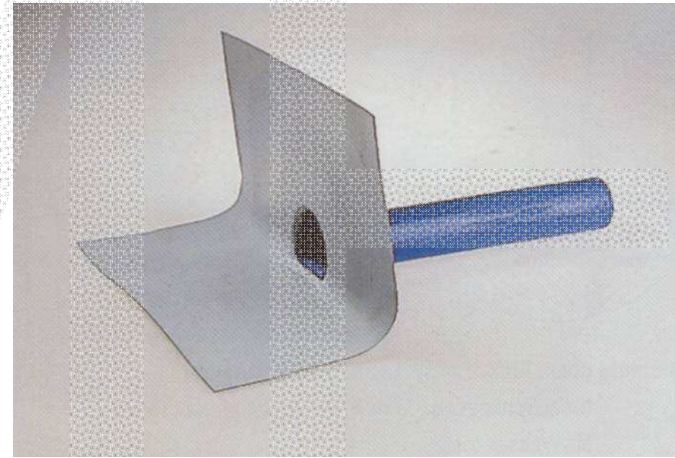
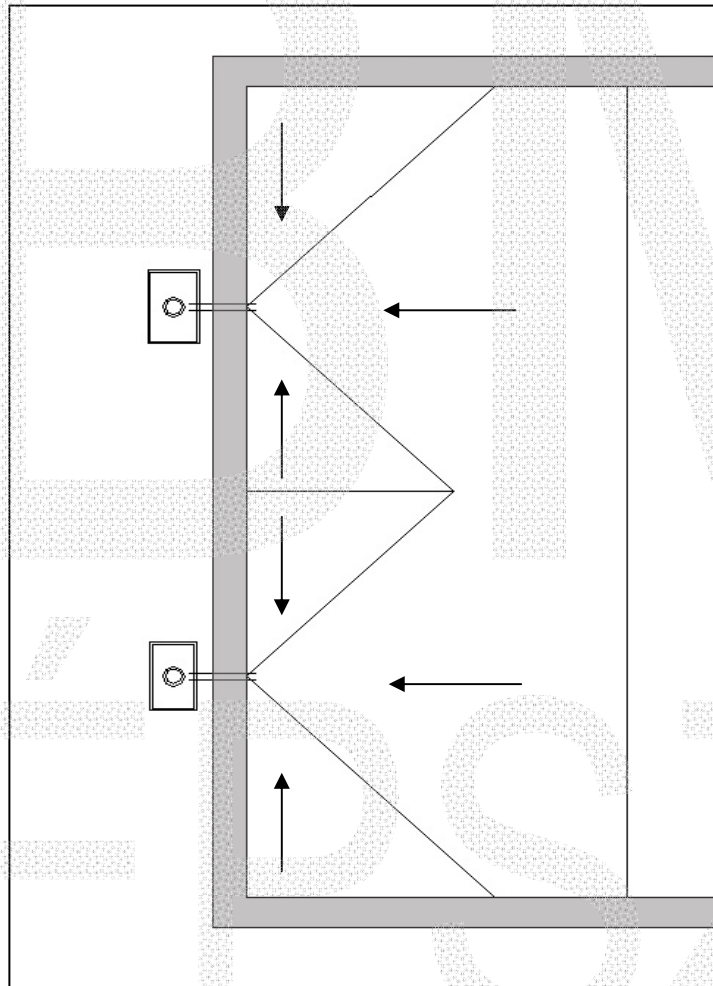



FLASHING OF PARAPET WALL

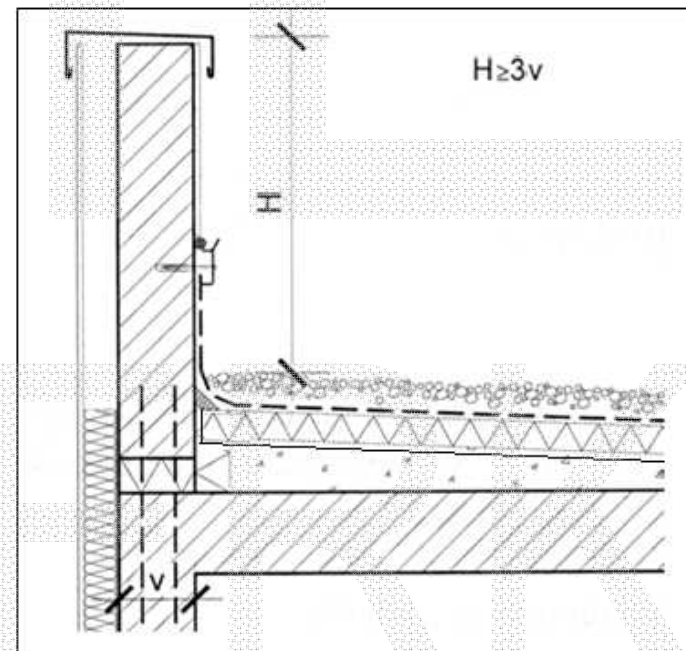
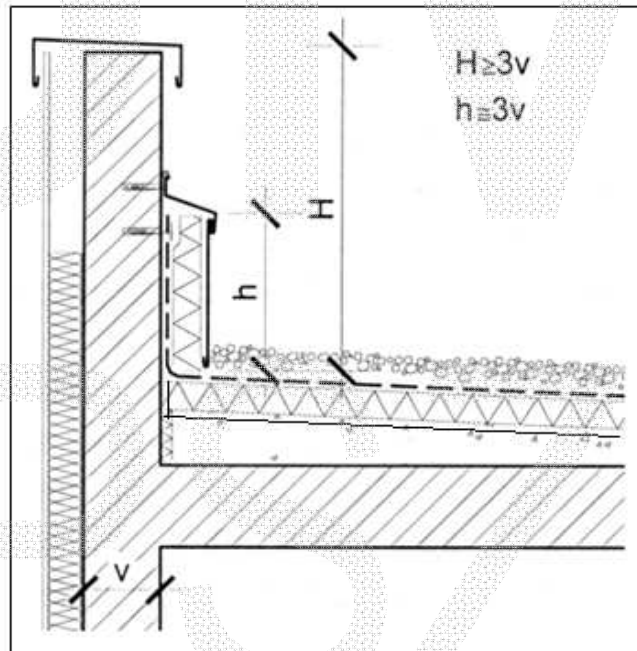
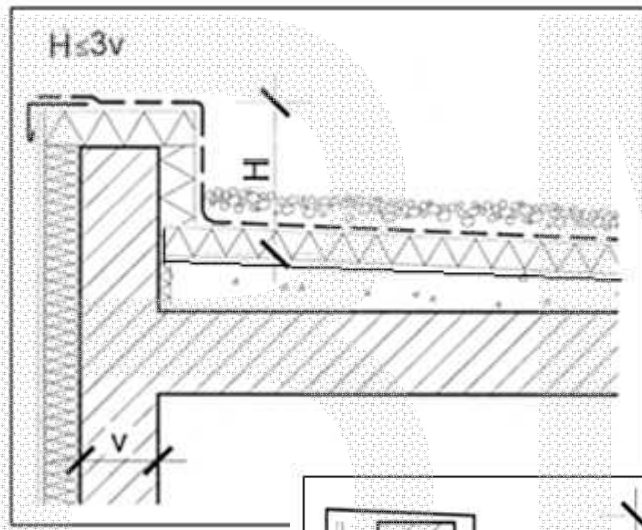

FLASHING

BITUMINOUS ROOFING MEMBRANES

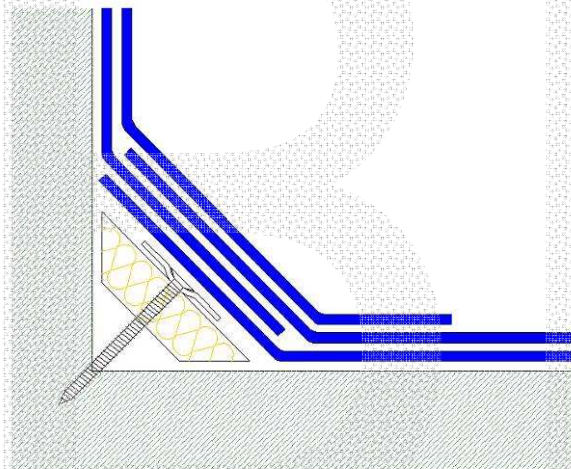

CORNER

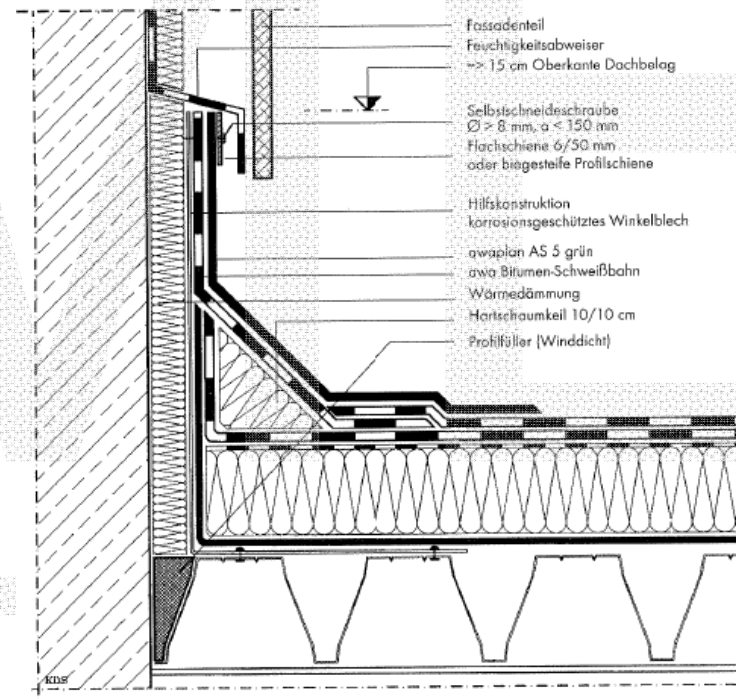
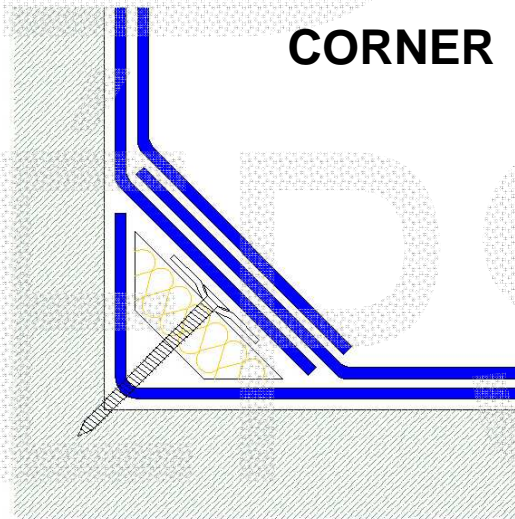

overlapping 8-10 cm
corner element !



FLASHING OF PARAPET WALL



•Non trafficked flat roof

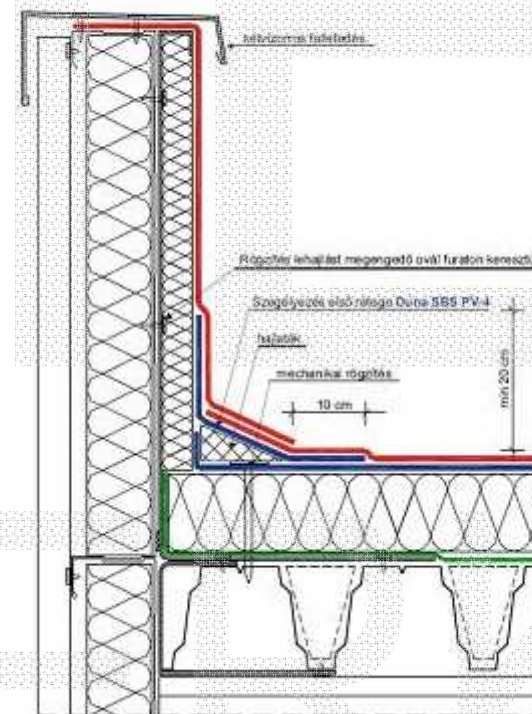
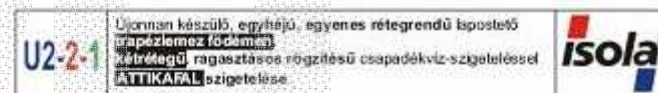

FLASHING

BITUMINOUS ROOFING MEMBRANES

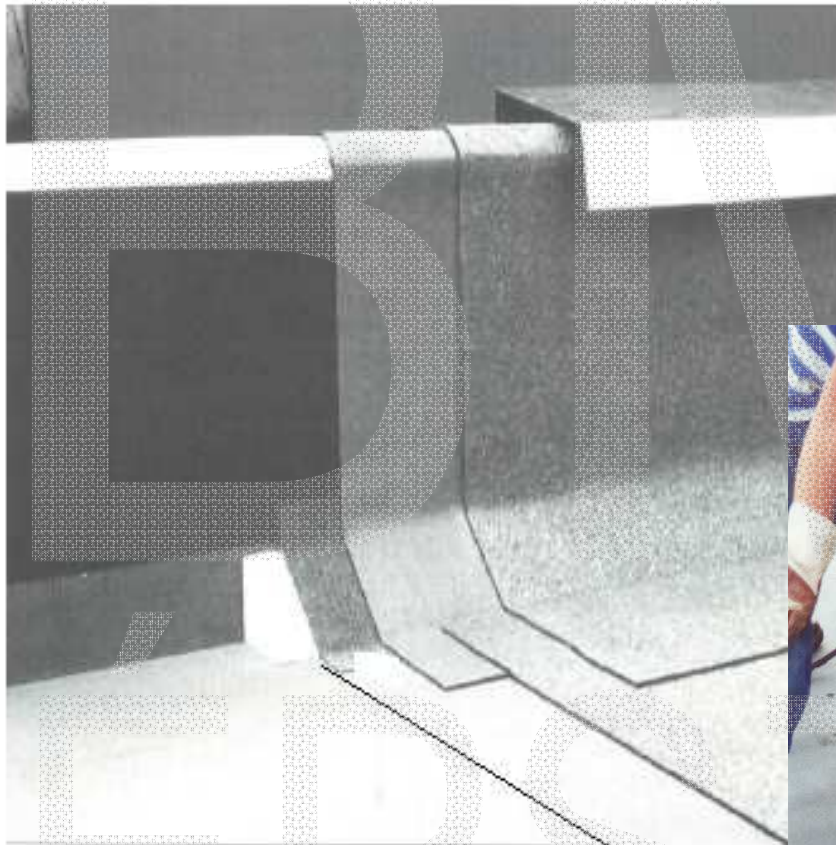

FLASHING

PLASTIC ROOFING MEMBRANES

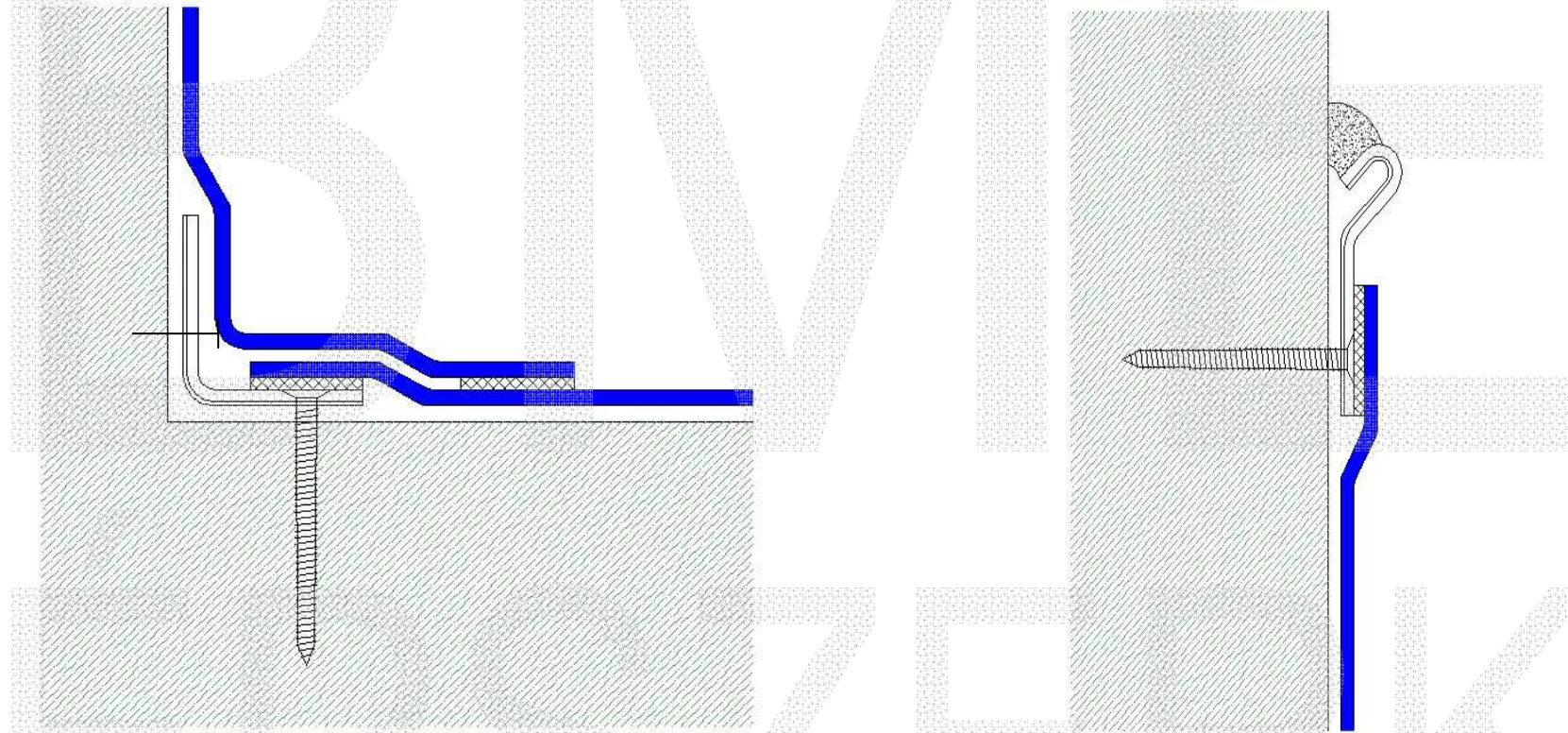

fixing at corner and on the wall by PVC laminated metal strip



FLASHING OF PARAPET WALL

PLASTIC (PVC) ROOFING MEMBRANES

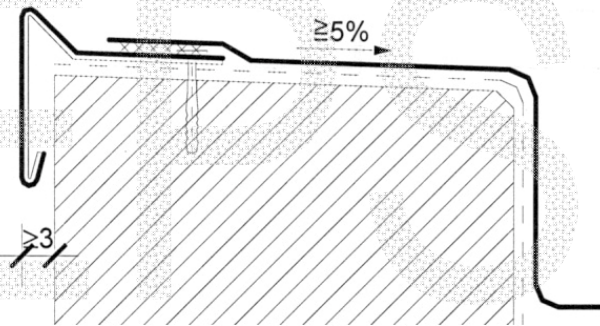
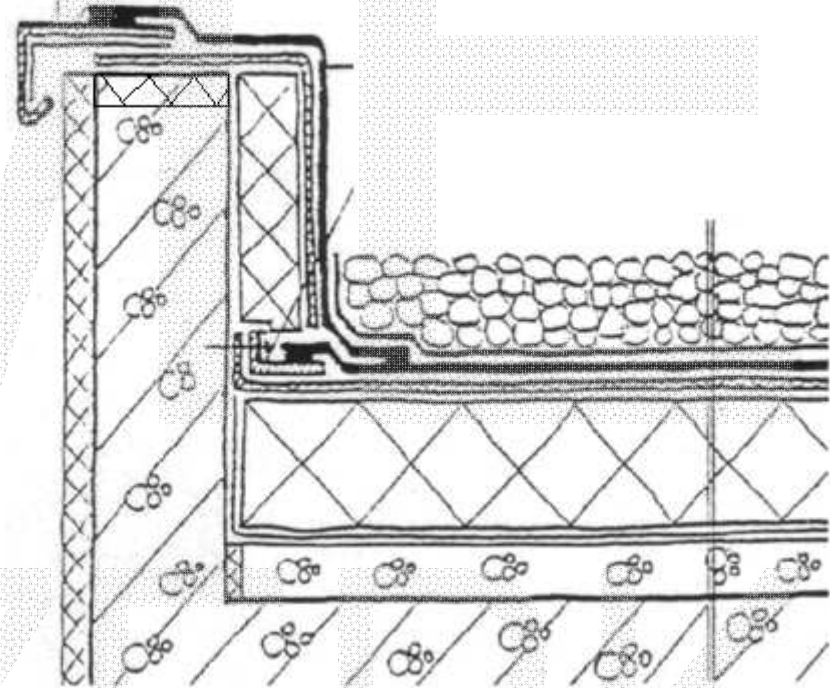

WATERPROOFING LAYER

PLASTIC (PVC) ROOFING MEMBRANES

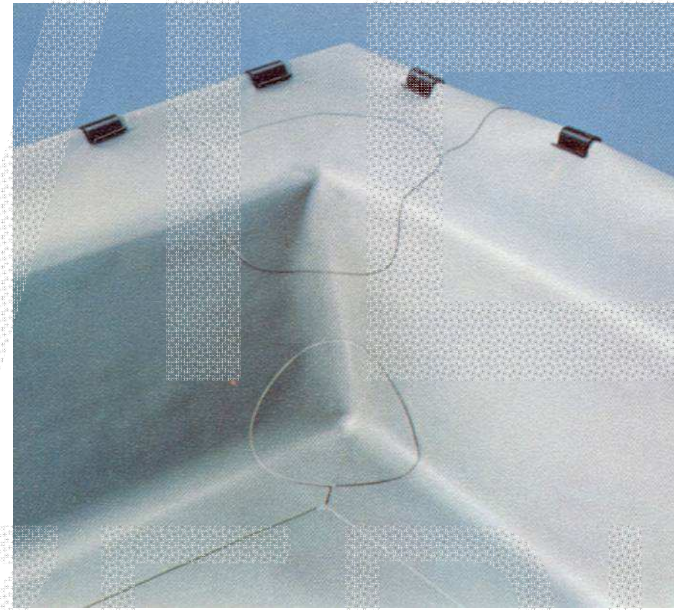

INTERNAL CORNER



WATERPROOFING LAYER

PLASTIC (PVC) ROOFING MEMBRANES

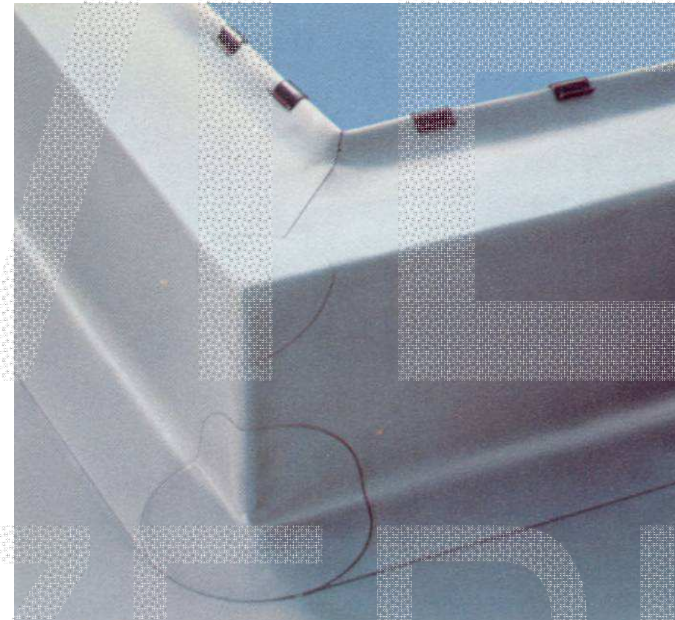
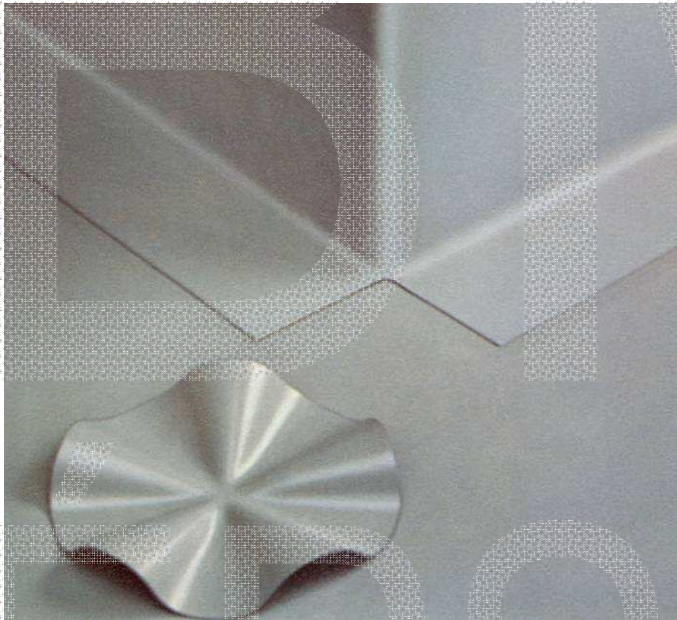

EXTERNAL CORNER



NON EXPLOITED FLAT ROOFS

CAP OF PARAPET WALL

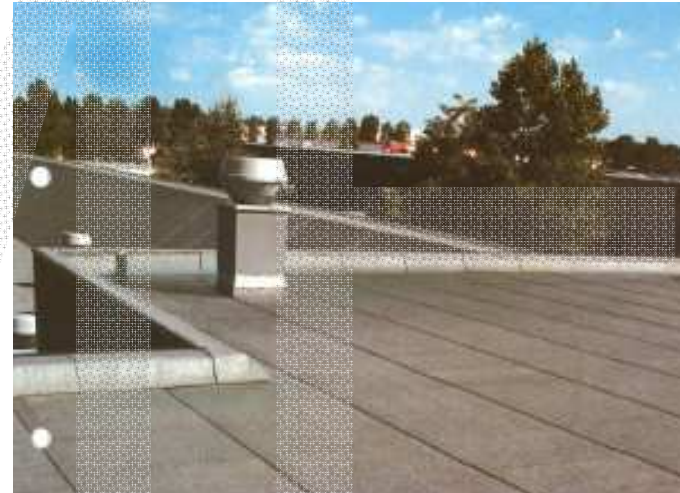
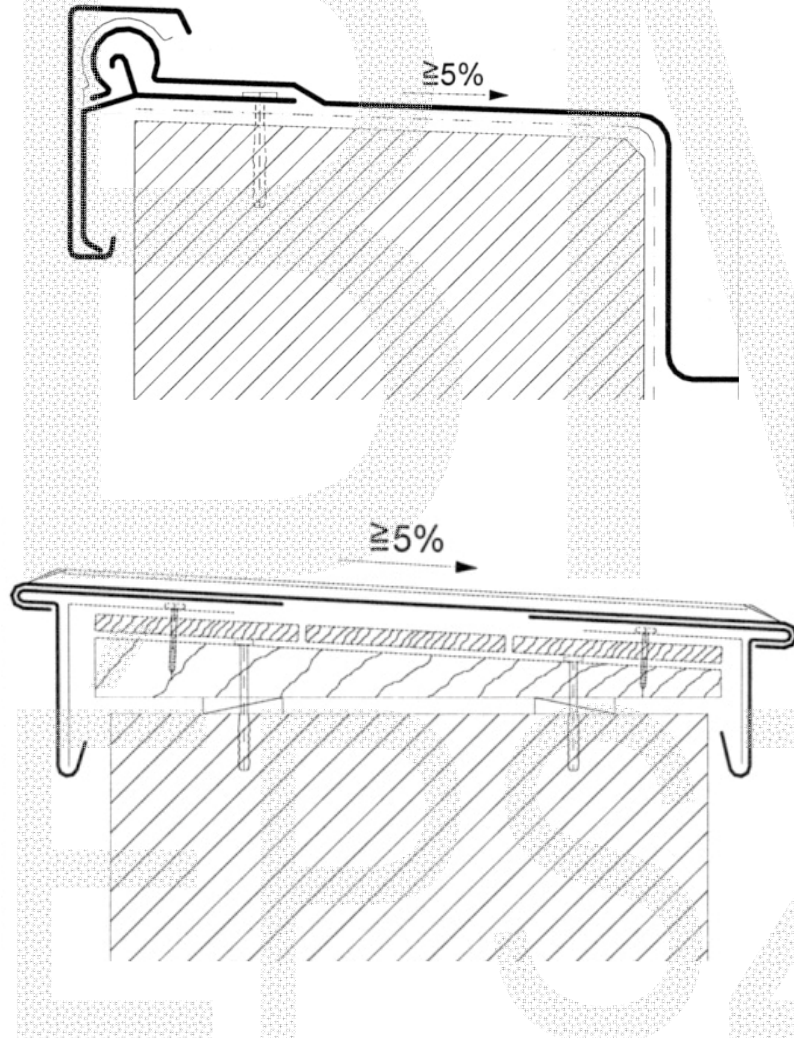

FLASHING OF ROOF EDGE

rules

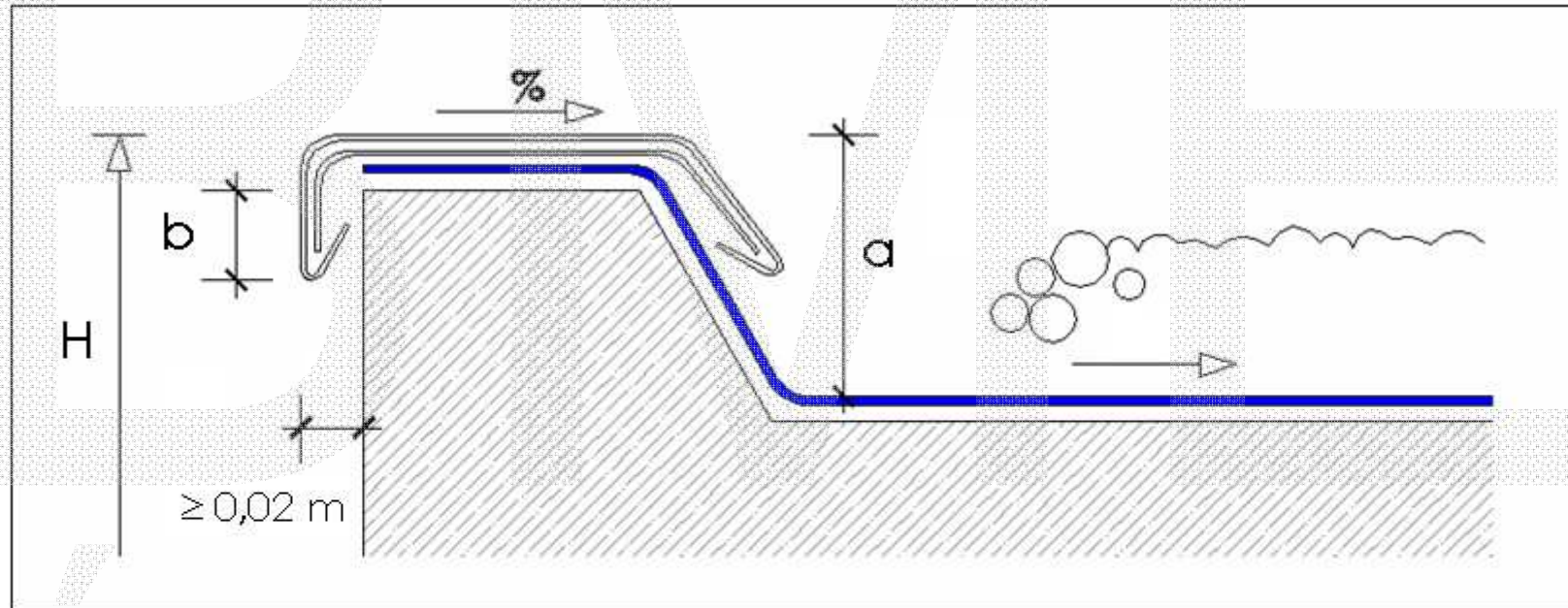

$\alpha \leq 5^\circ \rightarrow a \geq 0,10 \text{ m}$

$\alpha > 5^\circ \rightarrow a \geq 0,05 \text{ m}$

$H \leq 8 \text{ m} \rightarrow b \geq 0,05 \text{ m}$

$20 \text{ m} > H > 8 \text{ m} \rightarrow b \geq 0,08 \text{ m}$

$20 \text{ m} \leq H \rightarrow b \geq 0,10 \text{ m}$



FLASHING OF PARAPET WALL

rules

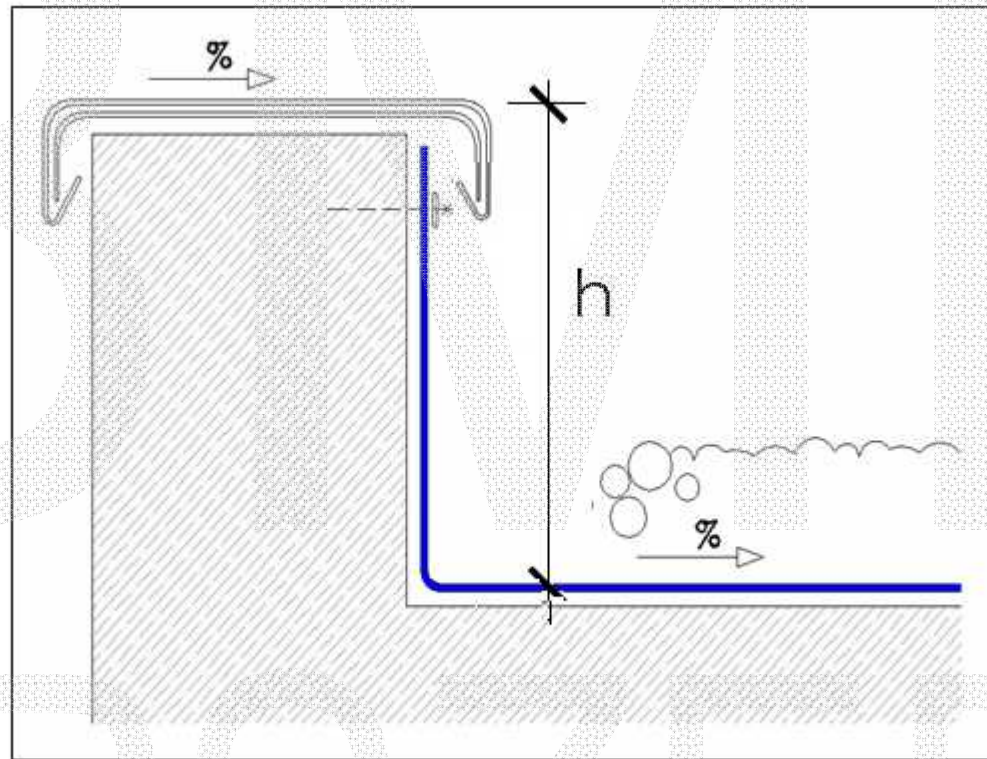

$$25 \text{ cm} < h \leq \text{cca } 80 \text{ cm}$$



FLASHING OF PARAPET WALL

rules

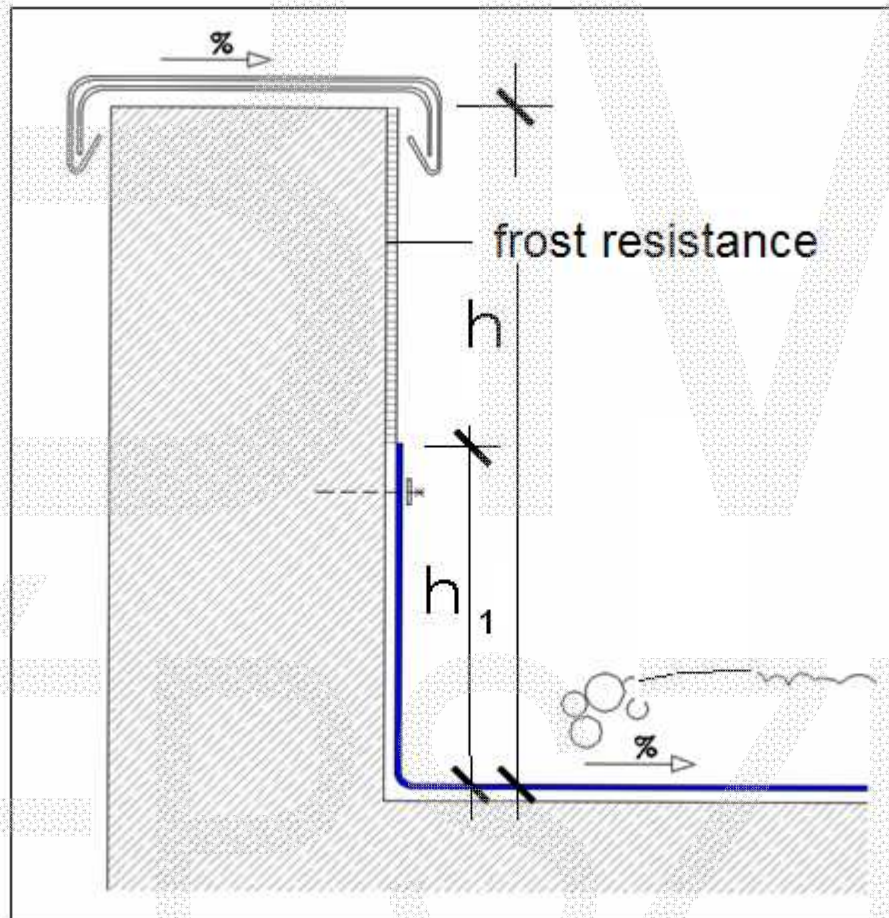

$$h > \text{cca } 80 \text{ cm}$$

$$h_1 \geq 25 \text{ cm}$$



FLASHING OF ABUTMENT WALL

rules

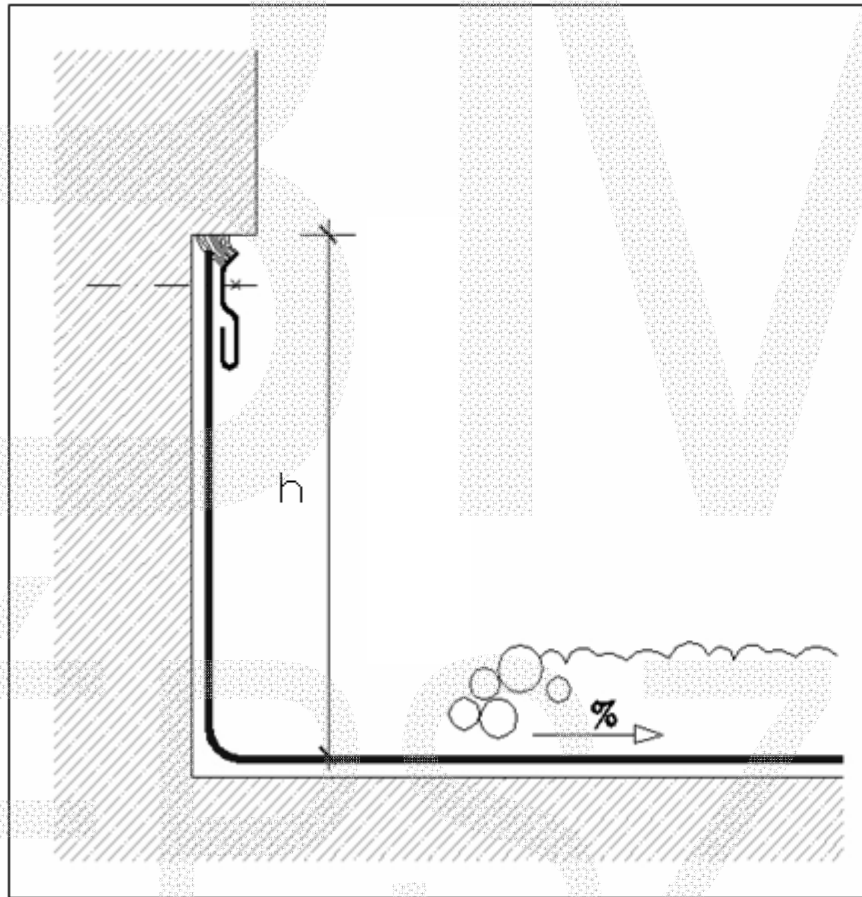

$$h \geq 0,25 \text{ m}$$



FLASHING AT THRESHOLD

rules

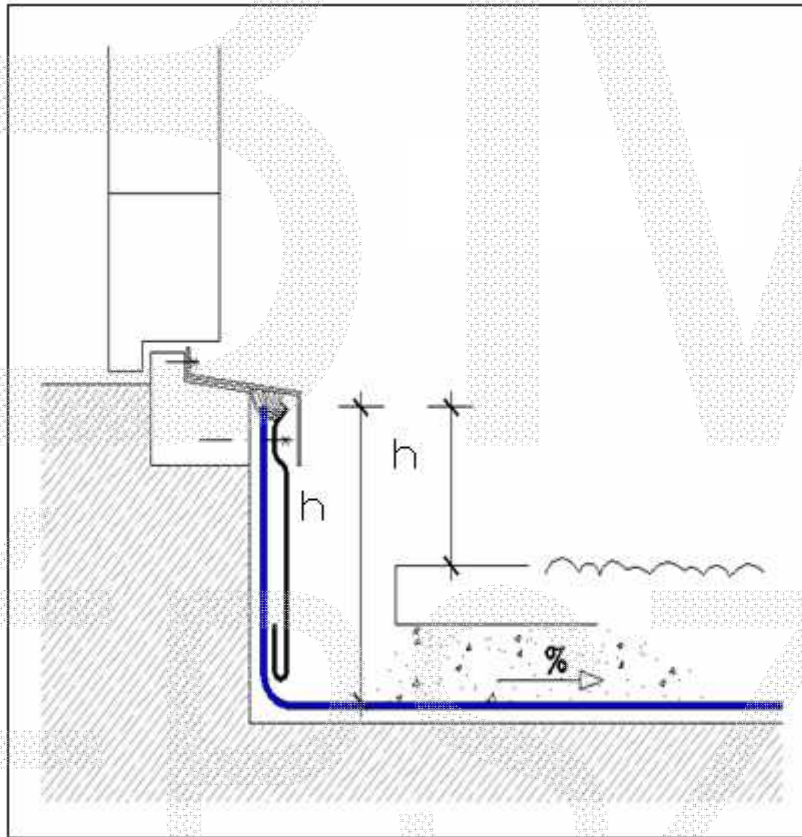

$$h \geq 0,25 \text{ m}$$



FLASHING AT TRESHOLD



FLASHING AT SKYLIGHT

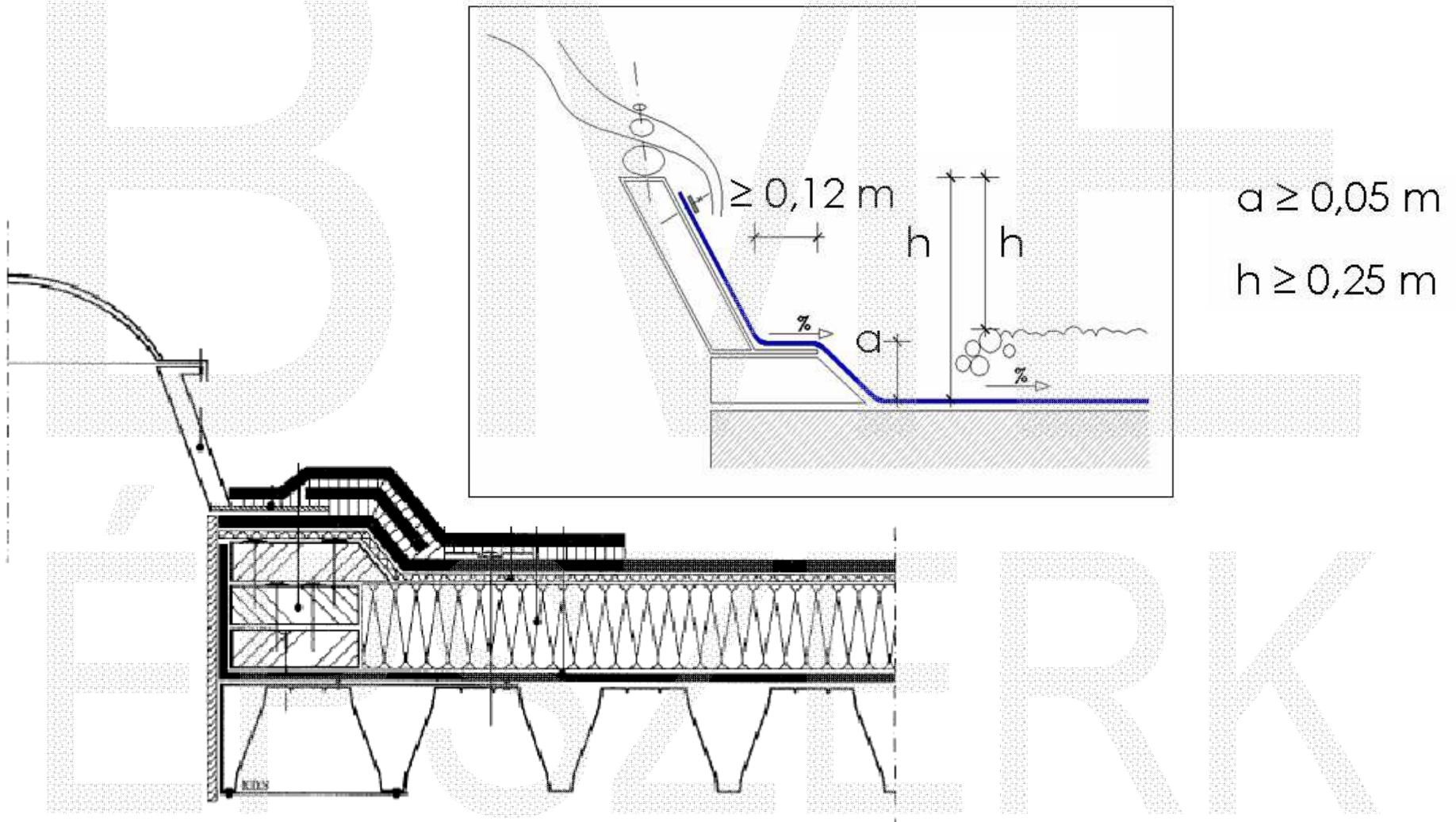

PIPE FLASHING

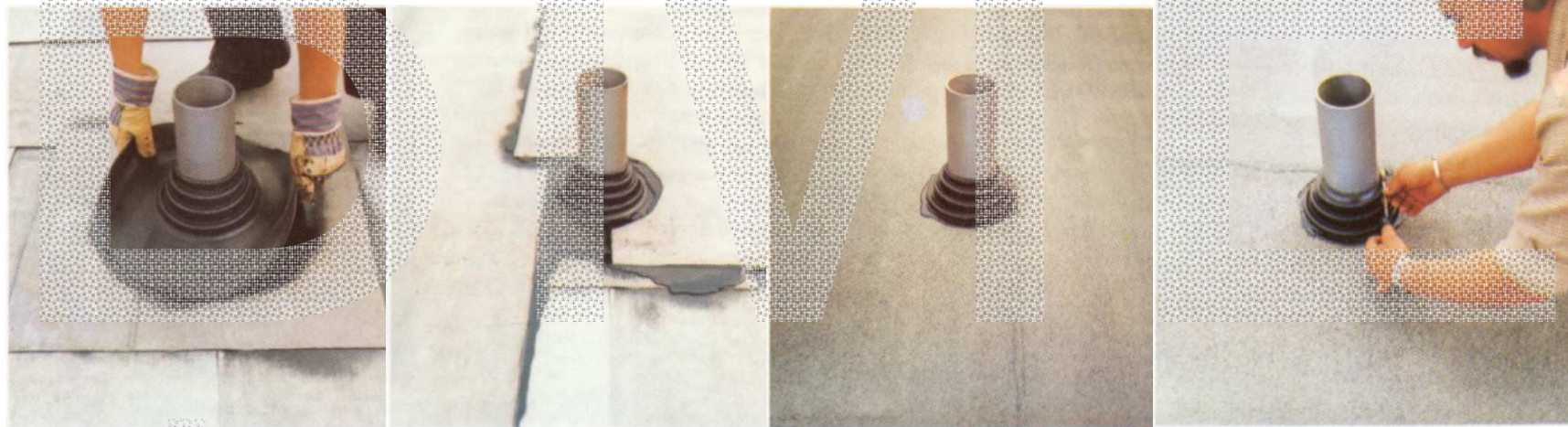

BITUMINOUS ROOFING MEMBRANES



PIPE FLASHING

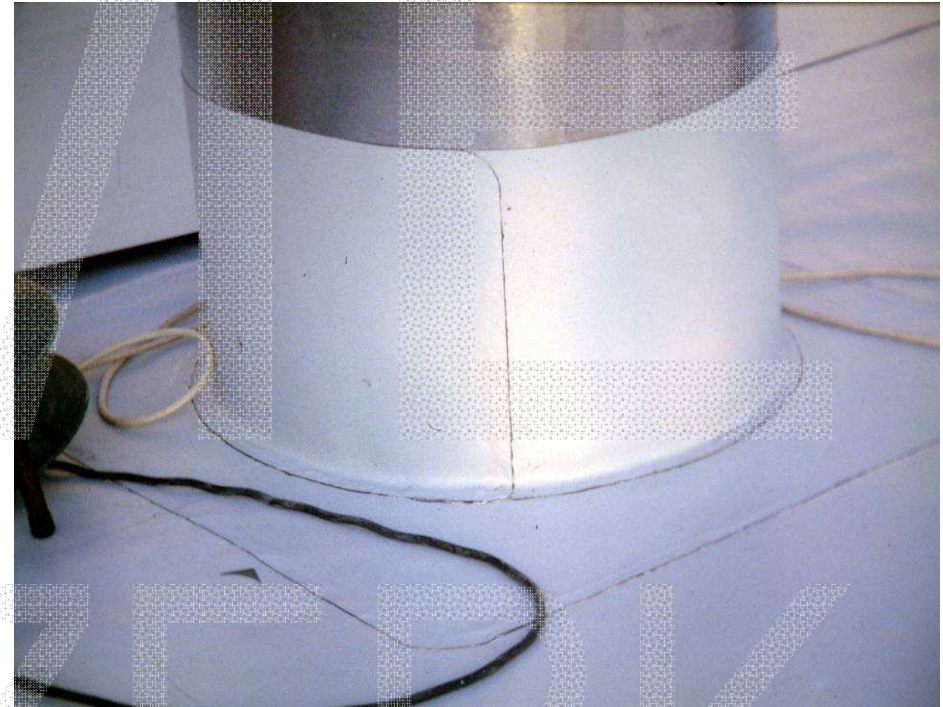

PLASTIC (PVC) ROOFING MEMBRANES



THANK YOU FOR YOUR
ATTENTION!

zsfulop@epsz.bme.hu

