

Scale S=1:5

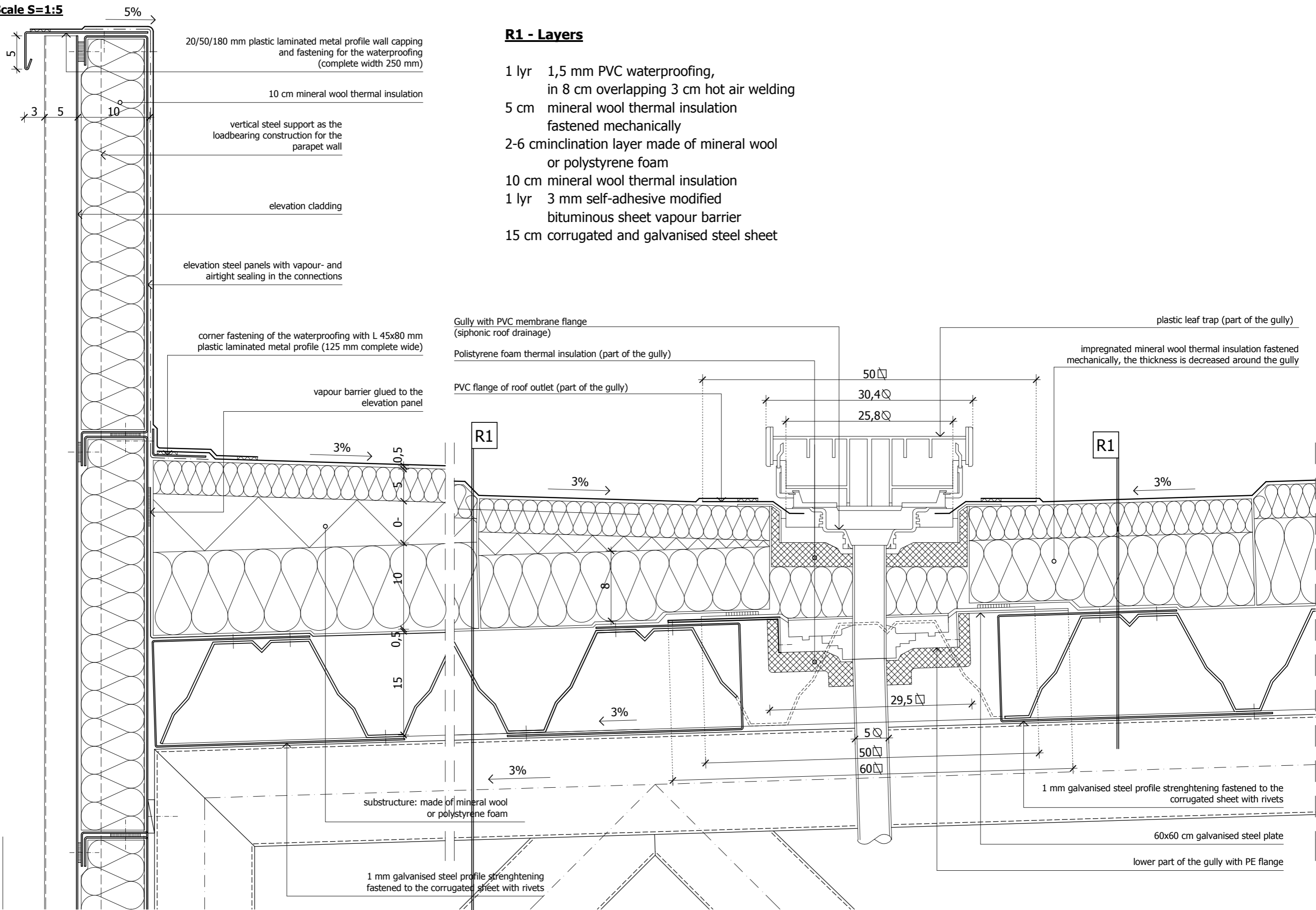

R1 - Layers

- 1 lyr 1,5 mm PVC waterproofing, in 8 cm overlapping 3 cm hot air welding
- 5 cm mineral wool thermal insulation fastened mechanically
- 2-6 cm inclination layer made of mineral wool or polystyrene foam
- 10 cm mineral wool thermal insulation
- 1 lyr 3 mm self-adhesive modified bituminous sheet vapour barrier
- 15 cm corrugated and galvanised steel sheet