

Drainage layout
S=1:50

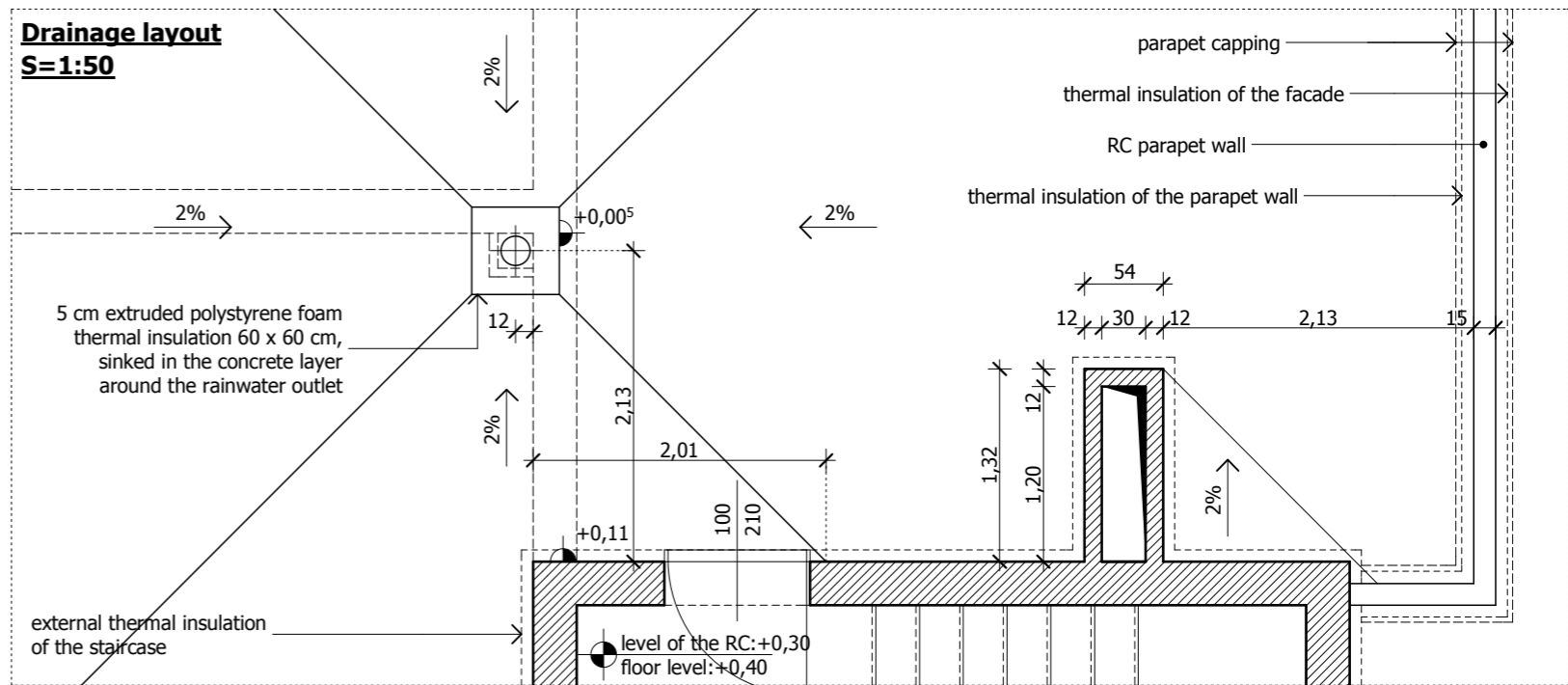

R2 layers:

- 5 cm Ø16-32 mm gravel ballasting and protecting layer
- 1 layer synthetic filter with specific density of 125 g/m²
- 20 cm extruded polystyrene foam (XPS) thermal insulation, with staggered joints
- 1 layer 4 mm modified bitumen waterproofing membrane (polyester fibre reinforced), fully bonded by torch applied welding
- 1 layer 4 mm modified bitumen waterproofing membrane (glass fibre reinforced), fully bonded
- 1 layer cold bitumen patching compound (about 300 g/m²)
- 4- cm concrete inclination layer (substructure), expansion joints at every 50m²
- 20 cm monolithic reinforced concrete floor slab

